



Today's discovery tomorrow's lifestyle

## About "Customers"

TM's involvement in the field of education and research contributes highly to the development of the information communications super highway and the MSC.

**Telekom Research & Development Sdn Bhd** represents the forefront for R&D activities in *Telekom Malaysia Berhad* and plays a leading role for new technologies through designing, fabrication and calibration for telecommunications industries.

**TMR&D**, a wholly owned subsidiary of *Telekom Malaysia Bhd.(TM)* started its operation on 1st January 2001 as the **R&D** arm to support current and future business of *TM*. We have the vision to become a technology company and a leading force in the market through research, development and innovation in the Information and Communication Technology (ICT) industry. In our journey to achieve the vision, we have continuously improved our services to our customers and we are glad to inform that we managed to obtain the prestigious ISO 9001-2000 certification in October 2002.

**R&D** management is unique due to the unpredictable market demand for state-of-art product and services. To succeed, risk due to the rapid change in technology needs to be mitigated and the needs of a talented work-force met.

### Research Themes

#### Access

The last mile network infra and facilities connecting homes and businesses to the Broadband Superhighway.

#### Green

Products and services that promote the minimum degradation of the environment.

#### Operational Excellence

Initiatives that support operational and business excellence.

#### HSBB

Applications that promote the usage of HSBB networks.

<http://www.tmrnd.com.my/>

## Benefits

- Fast & Accurate Results, Time Collaboration, 2D/3D Integration, 2D/3D Transition, Data Exchange, efficient large assembly & excellent documentation presentation/simulation

## Why IME

Continuous technical support, professional guidance, user community, nurturing campaign, reliable & competence in consulting customer projects.

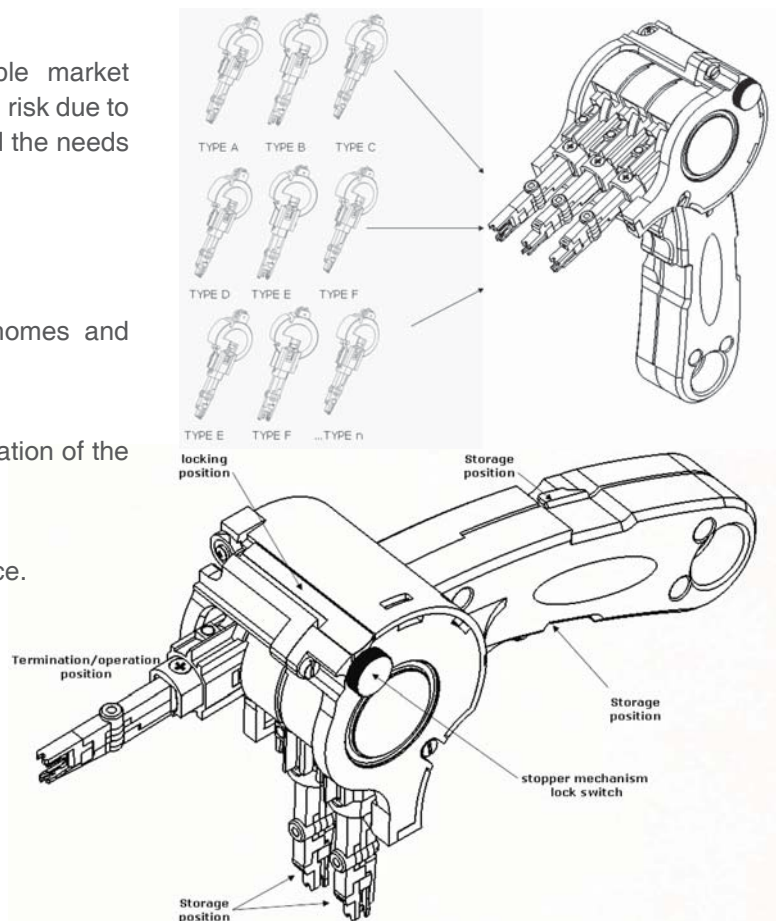

### Success Metrics

- i. Reduced the amount of time required to design packaging and general parts
- ii. Shortened development cycle by 25 to 30 percent
- iii. Shortened the design cycle by 30 to 50 percent
- iv. Saved time through integrated analysis
- v. Lower number of trials & errors
- vi. Increase success rate & decrease number of prove of concept test

#### ↳ Industry:

*Telecommunication Research & Development  
(Product Design/Solution & Development)*

#### Previous CAD :

*8 years*

#### Product(s) Used :

*SolidWorks Premium*

### Challenge

- Strict user requirement requested by customer & product safety compliance
- Design complexity & involve many tiny parts
- Lowered design costs by at least 30 percent compared to market
- Created design that decreased part costs
- Produce concept solution or product that satisfied the future customer/research custodian

### Solution

- Reduced number of design errors
- Increased manufacturability by 30 percent
- Improved collaboration between mechanical design engineers and electrical & electronic researchers
- Supported modular design for ease of assembly
- Increase decision making process in design stages via available simulation tools and collision detection tools



Click here for  
**SolidWorks  
Trial  
Version**

### About IME Technology

IME TECHNOLOGY is the most established SolidWorks Certified Sales, Training and Support Centre in this region with 19 years of experiences that we learned from our customers. Through innovation, we are committed in providing a wide range of professional services to our valued customers. Leading by 2 SolidWorks Elite Engineers and backup by 8 certified SolidWorks expert (CSWE), IME technical support team will ensure the partnership between SolidWorks, IME and our customer will grow, shine and sustain. Our complete total solutions include 3D design, Analysis, flow simulation, Data Management, technical documentation and training services. Get the best solution from the best provider in Malaysia.



**IME TECHNOLOGY SDN. BHD.** (356192-T)  
22A, Jalan PJS 1/46, Petaling Utama,  
46150 Petaling Jaya, Selangor, Malaysia.

Tel : +603-7783 6866  
Fax : +603-7783 4384

Technical Support:  
swsupport@cadcam.com.my

[www.cadcam.com.my](http://www.cadcam.com.my)  
[www.imetech.com.my](http://www.imetech.com.my)

**Hotline: 1300-88-2797**